



90 CHRIST SCHOOL ROAD

ASHEVILLE, NORTH CAROLINA



FORMER CONSOLIDATED METCO MANUFACTURING SITE

- 122,400 SF Available
- All Utilities Available
- 9 Exterior Dock Doors
- 3 Drive-In Bays
- 24' - 44' Clear Height
- 3 Miles to US I-26 & 11 Miles to US I-40
- 4 Miles to Asheville Regional Airport
- \$4.50 / SF / YR for Lease
- Established Infrastructure
- Convenient South Asheville location

PLEASE CONTACT US

CLARK DUNCAN | Senior Vice President of Economic Development
828.258.6134, cduncan@ashevillechamber.org

Site Description: Situated on approximately 6.5 acres, this building is available for lease with 67,594 SF of Manufacturing space, 43,680 SF of Warehouse space, and 11,118 SF of Office space in South Asheville, North Carolina. Located 3 miles to I-26 and 11 miles to I-40. Additionally located 4 miles from the Asheville Regional Airport and 4 miles from Biltmore Park Town Square. This site is partially built-out and occupancy available after 30 days from lease agreement. Nearby industries included Eaton Corporation, Linamar, Sierra Nevada, Wilsonart, Mainetti USA, Crane Creek Cycling, etc.

Location: 90 Christ School Rd, Arden NC 28704 (South Buncombe County)

Zoning: EMP (Industrial Purposes, etc.)

Use: Former Manufacturing

Water: City of Asheville – on site

Sewer: Metropolitan Sewerage District – on site

Gas: Dominion Energy – on site

Power: Duke Energy – on site

Fiber: Provider of choice – on site

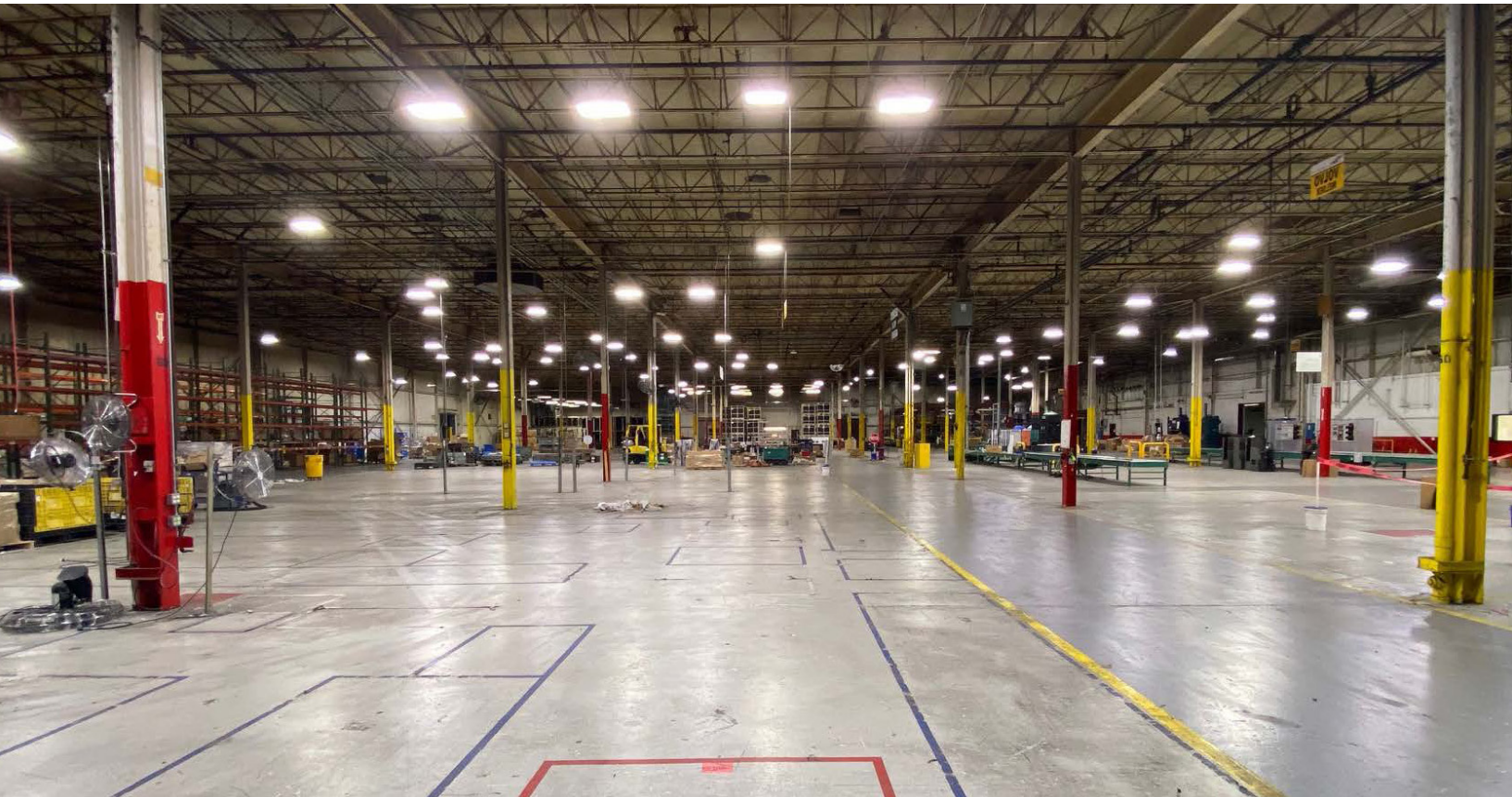

PLEASE CONTACT US

CLARK DUNCAN | Senior Vice President of Economic Development
828.258.6134, cduncan@ashevillechamber.org

Photo Gallery

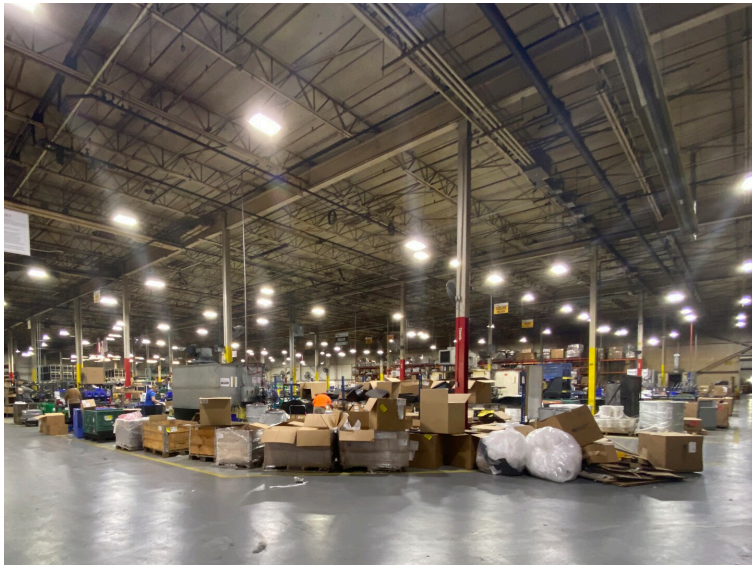

PLEASE CONTACT US

CLARK DUNCAN | Senior Vice President of Economic Development
828.258.6134, cduncan@ashevillechamber.org

90 Christ School Road

Map ID / Legend of Site

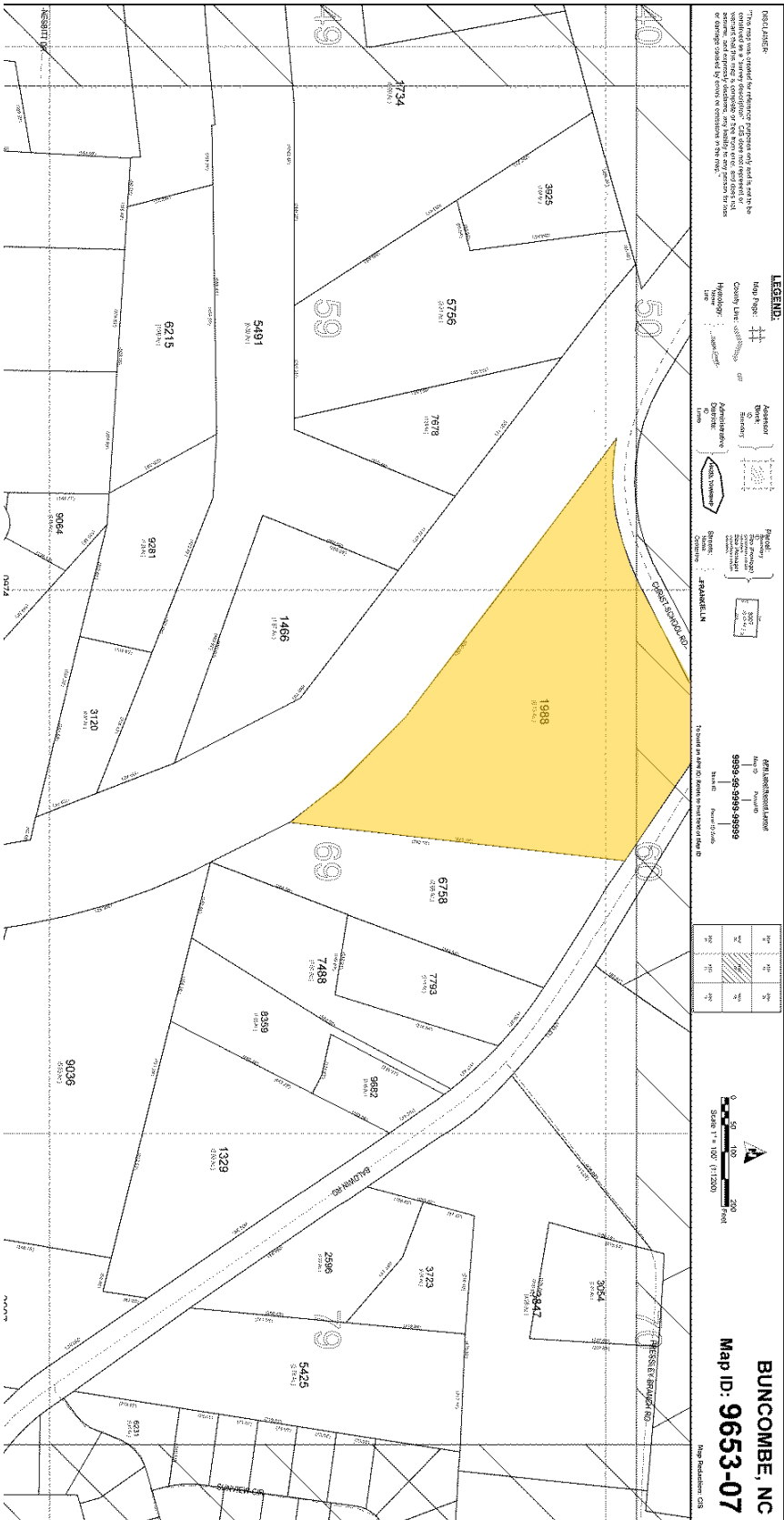

PLEASE CONTACT US

CLARK DUNCAN | Senior Vice President of Economic Development
828.258.6134, cduncan@ashevillechamber.org